

Local expertise with powerful national marketing

EDWARDS
ESTATE AGENTS



WEST BOROUGH

WIMBORNE, BH21 1PR



TWO BEDROOM FIRST
FLOOR APARTMENT
JUST A SHORT WALK
FROM THE SQUARE

GUIDE PRICE £190,000

- **FIRST FLOOR APARTMENT**
- **TWO BEDROOMS**
- **OPEN PLAN LIVING SPACE**
- **BATHROOM**

A rare opportunity to acquire a town centre two bedroom first floor apartment. Set within a period building with large sash windows flooding rooms with natural light and just a few steps from Wimborne Square. Stylishly finished, this immaculate property also offers a well proportioned living room/kitchen and modern bathroom. An ideal first home, bachelor pad or investment buy.

The main entrance door to a total of three apartments within the building, is located at the side of the property and stairs rise to the first floor and door leading to the first floor apartment. Opening to an entrance hall with doors leading to all rooms.

The sitting room/diner/kitchen is a well proportioned room with large sash window overlooking the road below. The kitchen is

- **STYLISHLY PRESENTED**
- **TOWN CENTRE LOCATION**
- **CHARACTER BUILDING**
- **NO FORWARD CHAIN**

fitted with a generous range of light, contemporary style base and wall units with worktop over. Built under stainless steel oven with inset, four burner gas hob and chimney extractor above. Integrated fridge/freezer. Inset single drainer sink with mixer tap. Space for free standing, under counter white goods. Wood effect flooring in vicinity of base units and carpet to remainder of floor space.

Both bedrooms are carpeted and each has a large sash window overlooking the road. The bathroom is stylishly fitted with a white, three piece suite including bath, pedestal wash hand basin and low level WC. Wood effect flooring. Part tiled walls.

EPC: D

Council Tax Band: tba

Services: Mains Electric, Gas and Mains Drainage



Local expertise with powerful national marketing

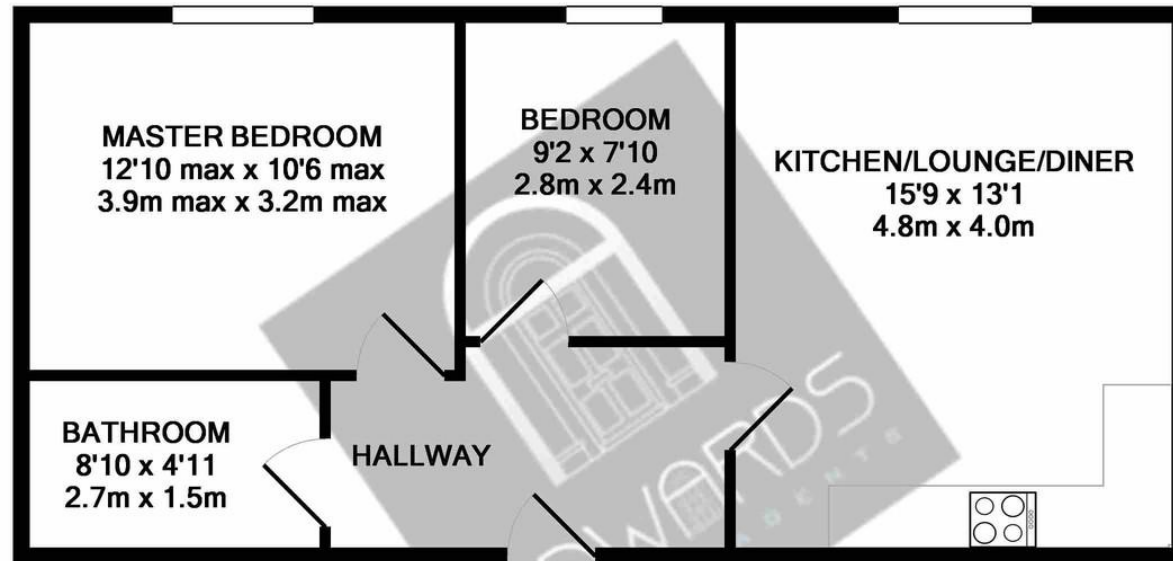

TOTAL APPROX. FLOOR AREA 532 SQ.FT. (49.4 SQ.M.)

Whilst every attempt has been made to ensure the accuracy of the floor plan contained here, measurements of doors, windows, rooms and any other items are approximate and no responsibility is taken for any error, omission, or mis-statement. This plan is for illustrative purposes only and should be used as such by any prospective purchaser. The services, systems and appliances shown have not been tested and no guarantee as to their operability or efficiency can be given

Made with Metropix ©2018

Wimborne Sales Office

47 East Street, Wimborne, Dorset, BH21 1DX • www.edwardestates.com

01202 842842 • info@edwardestates.com

EDWARDS
ESTATE AGENTS

These particulars are believed to be correct but their accuracy is not guaranteed and they do not form part of any contract. Whilst every effort is made to ensure the accuracy of these details, it should be noted that the above measurements are approximate only. Floorplans are for representation purposes only and prepared according to the RICS Code of Measuring Practice by our floorplan provider. Therefore, the layout of doors, windows and rooms are approximate and should be regarded as such by any prospective purchaser. Any internal photographs are intended as a guide only and it should not be assumed that any of the furniture/ fittings are included in any sale. Where shown, details of lease, ground rent and service charge are provided by the vendor and their accuracy cannot be guaranteed, as the information may not have been verified and further checks should be made either through your solicitor/conveyancer or by referring to the home information pack for this property. Where appliances, including central heating, are mentioned, it cannot be assumed that they are in working order, as they have not been tested. Please also note that wiring, plumbing and drains have not been checked.