

Local expertise with powerful national marketing

EDWARDS
ESTATE AGENTS

FLAT 8, HOLLY TREE

DORSET, BH9 2DE



HOLLY TREE

- **NEW BUILD FIRST FLOOR THREE BEDROOM APARTMENT**
- **MODERN FULLY TILLED BATHROOM**
- **NEW HOME GUARANTEE**
- **GAS CENTRAL HEATING**
- **DOUBLE GLAZING THROUGHOUT**
- **INTEGRATED KITCHEN APPLIANCES**
- **GREAT LOCATION IN MOORDOWN**
- **QUARTZ STONE WORKTOP SURFACES**

Edwards are pleased to bring to the market this three bedroom new build first floor apartment in the sought after location of Moordown with local amenities close by.

The entrance to this apartment is through the spacious living room, with access to all other rooms also. The whole apartment has a premium contemporary style after being recently refurbished. The modern and sleek kitchen benefits from full range of integrated appliances, Quartz stone work surfaces and plenty of cupboard space. The master bedroom is the largest of the three and benefits from an ensuite bathroom.

This property is on the Moordown/Winton highstreet with a wide range of shops, restaurants, bars and entertainment within walking distance, Castlepoint Shopping Centre is also only 2 miles away with plenty to offer. Its in a great school catchment with Glenmoor and Winton Academies, Winton Primary and Hill

View Primary close by. There are excellent transport links within easy access, with Bournemouth Train station 3 miles away, Bournemouth airport 5 miles away, and regular busses running frequently and a bus stop outside the property.



Local expertise with powerful national marketing

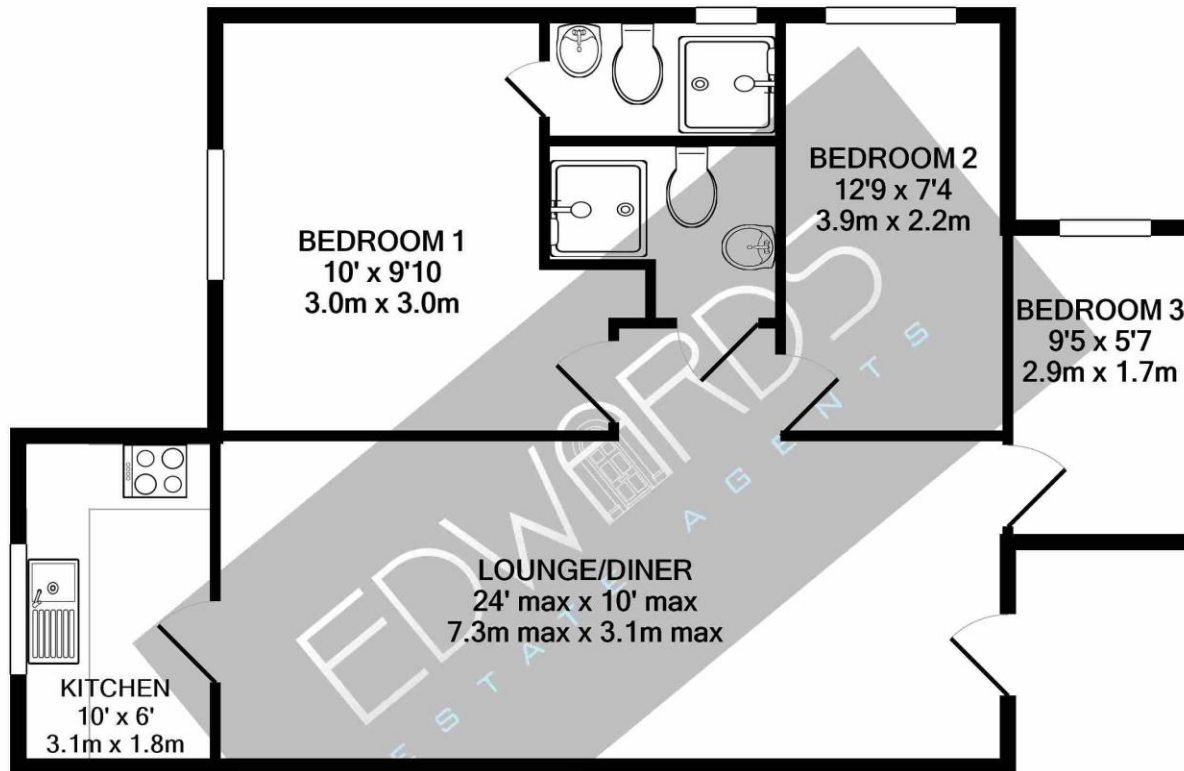

TOTAL APPROX. FLOOR AREA 659 SQ.FT. (61.3 SQ.M.)

Whilst every attempt has been made to ensure the accuracy of the floor plan contained here, measurements of doors, windows, rooms and any other items are approximate and no responsibility is taken for any error, omission, or mis-statement. This plan is for illustrative purposes only and should be used as such by any prospective purchaser. The services, systems and appliances shown have not been tested and no guarantee as to their operability or efficiency can be given

Made with Metropix ©2020

Bournemouth Sales

• www.edwardstates.com • 01202 744944 • bournemouth@edwardstates.com

EDWARDS
ESTATE AGENTS

These particulars are believed to be correct but their accuracy is not guaranteed and they do not form part of any contract. Whilst every effort is made to ensure the accuracy of these details, it should be noted that the above measurements are approximate only. Floorplans are for representation purposes only and prepared according to the RICS Code of Measuring Practice by our floorplan provider. Therefore, the layout of doors, windows and rooms are approximate and should be regarded as such by any prospective purchaser. Any internal photographs are intended as a guide only and it should not be assumed that any of the furniture/ fittings are included in any sale. Where shown, details of lease, ground rent and service charge are provided by the vendor and their accuracy cannot be guaranteed, as the information may not have been verified and further checks should be made either through your solicitor/conveyancer or by referring to the home information pack for this property. Where appliances, including central heating, are mentioned, it cannot be assumed that they are in working order, as they have not been tested. Please also note that wiring, plumbing and drains have not been checked.