

Local expertise with powerful national marketing

EDWARDS
ESTATE AGENTS



THE CITRUS BUILDING, HORSESHOE COMMON

BOURNEMOUTH, DORSET, BH1 1AR



AN INCREDIBLE
LOCATION IN THE
HEART OF THE
TOWN CENTRE

THE CITRUS BUILDING

- EXCEPTIONAL TOWN CENTRE APARTMENT
- FANTASTIC CENTRAL LOCATION FOR BEACHES & AMENITIES

This thoughtfully positioned to the rear of the development and has a lovely quiet and peaceful feel to it. Throughout it is decorated in natural colours and soft tones, adding to the feeling of light and space.

The generous entrance hall has two very useful store cupboards, one housing the heat interface unit, the other being plumbed so that it doubles as a utility cupboard.

The heart of this wonderful property is its fabulous open plan kitchen/living space. It comprises a very bright and well-planned sitting /dining area

- CONTEMPORARY STYLE BATHROOM
- TWO DOUBLE BEDROOMS
- JULIETTE BALCONY & FULL HEIGHT WINDOWS IN ALL ROOMS

with a Juliette balcony that is open plan to the most wonderful high quality fully fitted kitchen. The kitchen features smooth soft close doors and drawers with cool contemporary natural quartz worktops. Kitchen appliances are by Smeg whilst the modern bathroom is Hansgrohe with a very useful heated mirror.

Both bedrooms are generously proportioned with the master having a large built-in wardrobe.

This fine apartment further benefits from secure parking within this fully gated video intercom development.



Local expertise with powerful national marketing

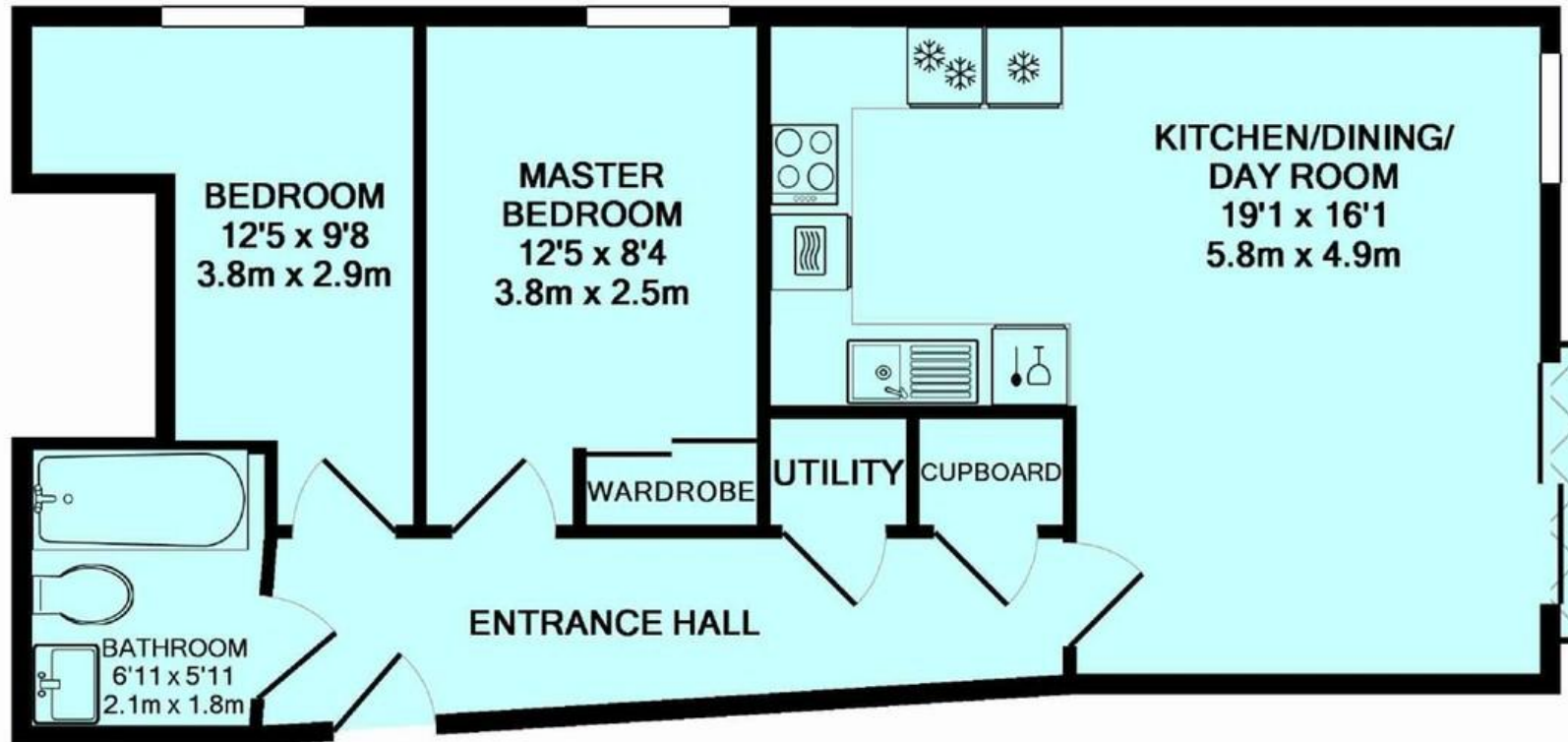

TOTAL APPROX. FLOOR AREA 594 SQ.FT. (55.2 SQ.M.)

Whilst every attempt has been made to ensure the accuracy of the floor plan contained here, measurements of doors, windows, rooms and any other items are approximate and no responsibility is taken for any error, omission, or mis-statement. This plan is for illustrative purposes only and should be used as such by any prospective purchaser. The services, systems and appliances shown have not been tested and no guarantee as to their operability or efficiency can be given

Made with Metropix ©2016

Bournemouth Sales

www.edwardstates.com • 01202 555550 • bournemouth@edwardstates.com

EDWARDS
ESTATE AGENTS

These particulars are believed to be correct but their accuracy is not guaranteed and they do not form part of any contract. Whilst every effort is made to ensure the accuracy of these details, it should be noted that the above measurements are approximate only. Floorplans are for representation purposes only and prepared according to the RICS Code of Measuring Practice by our floorplan provider. Therefore, the layout of doors, windows and rooms are approximate and should be regarded as such by any prospective purchaser. Any internal photographs are intended as a guide only and it should not be assumed that any of the furniture/ fittings are included in any sale. Where shown, details of lease, ground rent and service charge are provided by the vendor and their accuracy cannot be guaranteed, as the information may not have been verified and further checks should be made either through your solicitor/conveyancer or by referring to the home information pack for this property. Where appliances, including central heating, are mentioned, it cannot be assumed that they are in working order, as they have not been tested. Please also note that wiring, plumbing and drains have not been checked.