

Local expertise with powerful national marketing

EDWARDS
ESTATE AGENTS



WIMBORNE ROAD

CORFE MULLEN, WIMBORNE, BH21 3DX



GUIDE PRICE £350,000

- DETACHED BUNGALOW
- TWO BEDROOMS
- MODERN KITCHEN
- STYLISH BATHROOM
- OFF ROAD PARKING
- PRIVATE REAR GARDEN
- POPULAR VILLAGE LOCATION
- NO FORWARD CHAIN

This two bedroom detached bungalow is located in the popular village of Corfe Mullen, with local amenities, transport links and well regarded schools nearby.

Approached across a neatly landscaped frontage with ample off road parking, the welcoming hallway gives access to all rooms. The well proportioned master bedroom overlooks the front of the property, whilst bedroom two has a window to the side elevation. The good size lounge has a window and fully glazed door giving access to an extensive patio to the rear and a recessed fireplace provides a focal point for those cosy winter evenings! The kitchen is stylishly fitted with contemporary, high gloss base and wall units with space for free standing under counter white goods. There is also a built under oven and five burner gas hob with extractor over. Fully glazed door leading to the rear garden.

The bathroom is fitted with a bath with shower above, wall hung vanity wash hand basin and semi-concealed WC.

Outside the rear garden enjoys a good degree of privacy with fencing and planting to boundaries. A generous patio is ideal for outdoor entertaining and the remainder is laid to neatly maintained lawn. To the rear of the plot there is a detached garage (no vehicular access).

EPC: D

DRAFT DETAILS AWAITING APPROVAL FROM THE VENDOR.



Local expertise with powerful national marketing

GROUND FLOOR
752 sq.ft. (69.9 sq.m.) approx.

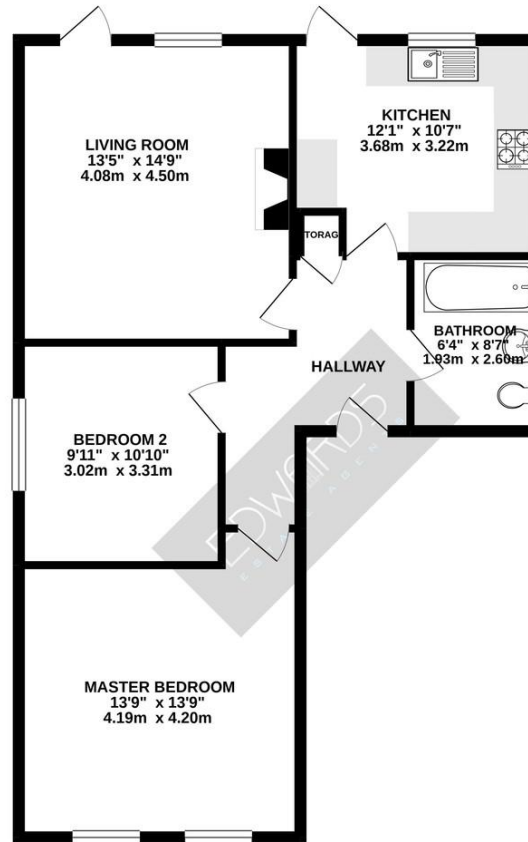

TOTAL FLOOR AREA: 752 sq.ft. (69.9 sq.m.) approx.

Whilst every attempt has been made to ensure the accuracy of the floorplan contained here, measurements of doors, windows, rooms and any other items are approximate and no responsibility is taken for any error, omission or mis-statement. This plan is for illustrative purposes only and should be used as such by any prospective purchaser. The services, systems and appliances shown have not been tested and no guarantee as to their operability or efficiency can be given.
Made with Metropix ©2021.

Wimborne Sales Office

47 East Street, Wimborne, Dorset, BH21 1DX • www.edwardestates.com

01202 842842 • info@edwardestates.com

EDWARDS
ESTATE AGENTS

These particulars are believed to be correct but their accuracy is not guaranteed and they do not form part of any contract. Whilst every effort is made to ensure the accuracy of these details, it should be noted that the above measurements are approximate only. Floorplans are for representation purposes only and prepared according to the RICS Code of Measuring Practice by our floorplan provider. Therefore, the layout of doors, windows and rooms are approximate and should be regarded as such by any prospective purchaser. Any internal photographs are intended as a guide only and it should not be assumed that any of the furniture/fittings are included in any sale. Where shown, details of lease, ground rent and service charge are provided by the vendor and their accuracy cannot be guaranteed, as the information may not have been verified and further checks should be made either through your solicitor/conveyancer or by referring to the home information pack for this property. Where appliances, including central heating, are mentioned, it cannot be assumed that they are in working order, as they have not been tested. Please also note that wiring, plumbing and drains have not been checked.