

*Local expertise with powerful national marketing*

EDWARDS  
ESTATE AGENTS

## THE LOOKOUT

---

POOLE, BH15 2RP

A modern kitchen interior featuring white shaker-style cabinetry. On the left, a built-in oven is visible. The countertop is made of light-colored wood. The backsplash consists of white tiles with a geometric, hexagonal pattern. A stainless steel sink with a modern faucet is on the right. The ceiling has several recessed lights, and a small window is visible in the background.

UNIQUE OPPORTUNITY TO BUY A ONE BEDROOM  
FLAT IN THIS EXCLUSIVE NEW DEVELOPMENT NEXT  
TO POOLE PARK VERY HIGH SPECIFICATIONS  
THROUGHOUT.



# THE LOOKOUT

---

- STUNNING RESIDENTS ROOF TERRACE WITH PANORAMIC HARBOUR VIEWS
- STYLISH HIGH SPEC KITCHEN & BATHROOM
- IDEAL 1ST TIME BUY
- BUY-TO-LET INVESTMENT OPPORTUNITY
- RARE 1 BED APARTMENT HERE - DON'T MISS OUT!

Fantastic opportunity to buy a sought after one bedroom apartment in this prestigious new build beside Poole Park and close to vibrant Ashley Cross. The block has been constructed to the highest specifications and offers stylish, modern living with luxurious attention to detail throughout.

This fourth-floor home boasts elegant neutral décor with a beautifully fitted kitchen including quality integrated appliances. The open plan kitchen/living space is bright and airy with floor to ceiling windows maximising natural light. The double bedroom is spacious, again with feature windows. There is a fully tiled bathroom including bath, shower w/c and basin, and a utility storage cupboard with washer/dryer.

A real feature of this block is the expansive residents roof terrace furnished with loungers and seating and offering panoramic views over Poole Harbour; the perfect place to relax or socialise.



*Local expertise with powerful national marketing*

**4TH FLOOR**  
**560 sq.ft. (52.1 sq.m.) approx.**

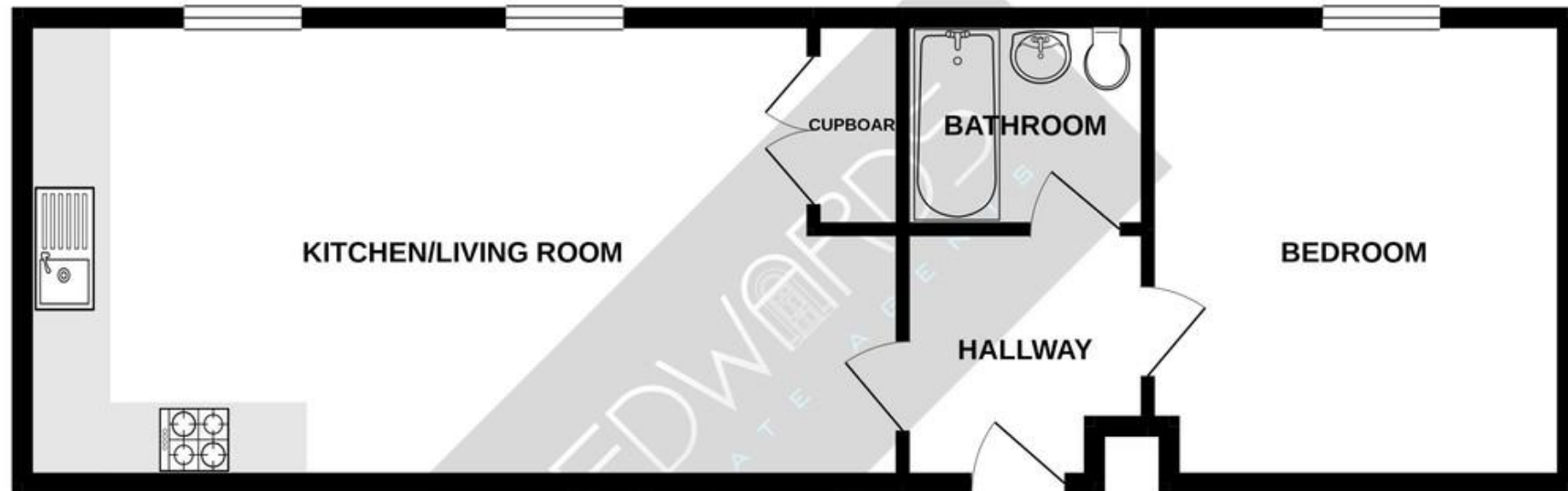

**TOTAL FLOOR AREA : 560 sq.ft. (52.1 sq.m.) approx.**

Whilst every attempt has been made to ensure the accuracy of the floorplan contained here, measurements of doors, windows, rooms and any other items are approximate and no responsibility is taken for any error, omission or mis-statement. This plan is for illustrative purposes only and should be used as such by any prospective purchaser. The services, systems and appliances shown have not been tested and no guarantee as to their operability or efficiency can be given.  
Made with Metropix ©2021

**Lower Parkstone Office**

34 Station Road, Parkstone, Poole, Dorset, BH14 8UD • [www.edwardestates.com](http://www.edwardestates.com)

01202 744944 • [lowerparkstone@edwardestates.com](mailto:lowerparkstone@edwardestates.com)

**EDWARDS**  
ESTATE AGENTS

These particulars are believed to be correct but their accuracy is not guaranteed and they do not form part of any contract. Whilst every effort is made to ensure the accuracy of these details, it should be noted that the above measurements are approximate only. Floorplans are for representation purposes only and prepared according to the RICS Code of Measuring Practice by our floorplan provider. Therefore, the layout of doors, windows and rooms are approximate and should be regarded as such by any prospective purchaser. Any internal photographs are intended as a guide only and it should not be assumed that any of the furniture/ fittings are included in any sale. Where shown, details of lease, ground rent and service charge are provided by the vendor and their accuracy cannot be guaranteed, as the information may not have been verified and further checks should be made either through your solicitor/conveyancer or by referring to the home information pack for this property. Where appliances, including central heating, are mentioned, it cannot be assumed that they are in working order, as they have not been tested. Please also note that wiring, plumbing and drains have not been checked.