

Local expertise with powerful national marketing

EDWARDS
ESTATE AGENTS

SHERINGHAM ROAD

POOLE, BH12 1NS

FINE & COUNTRY
Homes from Edwards



GUIDE PRICE £475,000

This detached three bedroom property is offered to the market in fantastic condition throughout, boasting modern décor and contemporary living.

Internally:

One double bedroom with shower room is situated on the ground floor making this ideal for conversion for use as an annexe or similar.

First floor comprises a brand new open plan kitchen/diner and living room fitted to provide more family living space. The kitchen comprises of: chalk wall fitted units, wooden worktops, under worktop units are a fantastic marine blue colour which matches the island, double oven, hob, extractor fan and light oak coloured flooring throughout. Double lead to the outside dining area at the rear of the property. Good size living room with modern décor throughout and matching flooring to the kitchen/diner.

Outside the contemporary theme is continued with fully landscaped grounds and gardens featuring block paved driveway offering ample parking. The rear garden is split level with low maintenance astroturf.









TOTAL FLOOR AREA : 1385 sq.ft. (128.6 sq.m.) approx.

Whilst every attempt has been made to ensure the accuracy of the floorplan contained here, measurements of doors, windows, rooms and any other items are approximate and no responsibility is taken for any error, omission or mis-statement. This plan is for illustrative purposes only and should be used as such by any prospective purchaser. The services, systems and appliances shown have not been tested and no guarantee as to their operability or efficiency can be given.
Made with Metropix ©2022

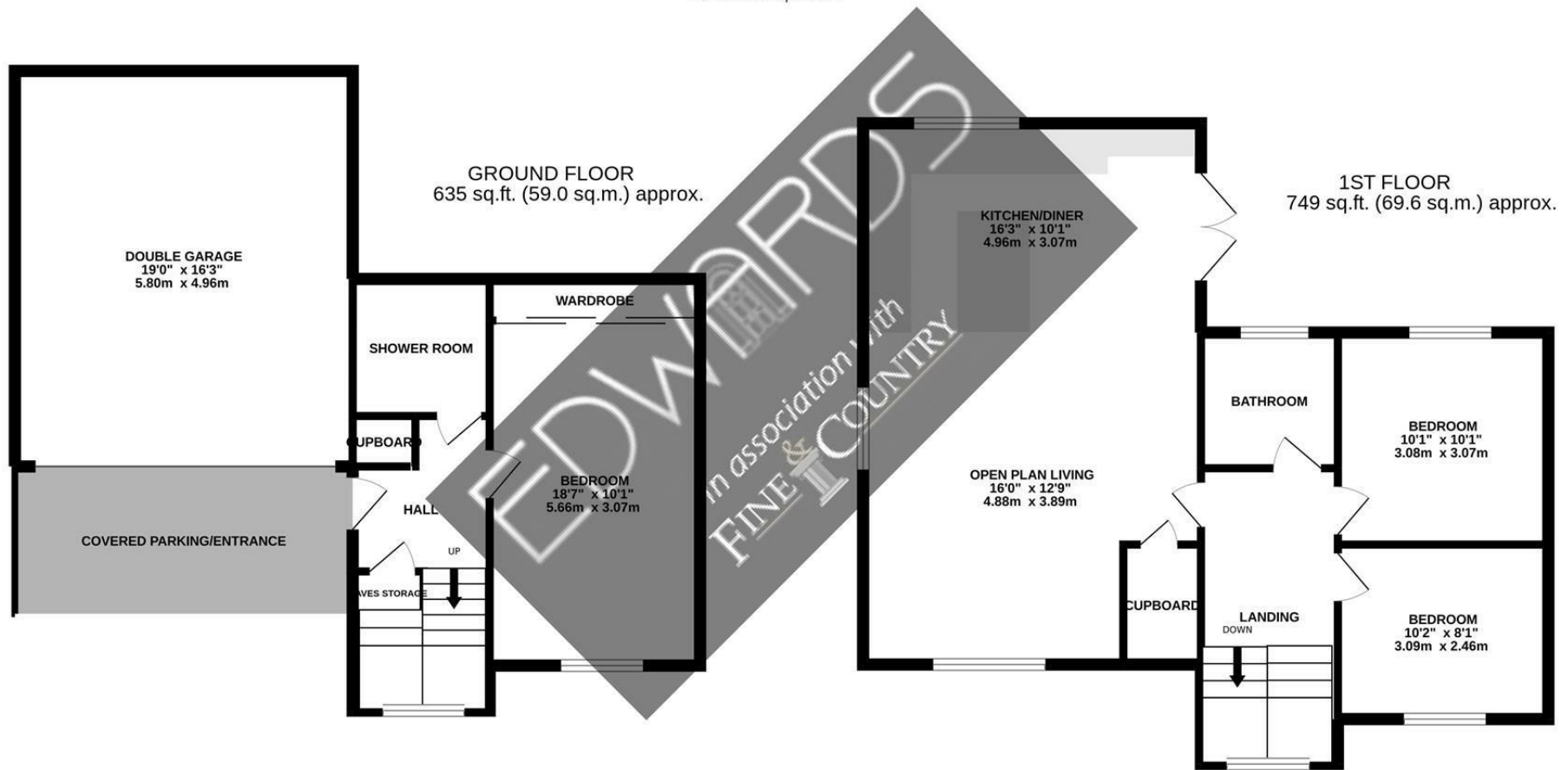

These particulars are believed to be correct but their accuracy is not guaranteed and they do not form part of any contract. Whilst every effort is made to ensure the accuracy of these details, it should be noted that the above measurements are approximate only. Floorplans are for representation purposes only and prepared according to the RICS Code of Measuring Practice by our floorplan provider. Therefore, the layout of doors, windows and rooms are approximate and should be regarded as such by any prospective purchaser. Any internal photographs are intended as a guide only and it should not be assumed that any of the furniture/ fittings are included in any sale. Where shown, details of lease, ground rent and service charge are provided by the vendor and their accuracy cannot be guaranteed, as the information may not have been verified and further checks should be made either through your solicitor/conveyancer or by referring to the home information pack for this property. Where appliances, including central heating, are mentioned, it cannot be assumed that they are in working order, as they have not been tested. Please also note that wiring, plumbing and drains have not been checked.

Local expertise with powerful national marketing

EDWARDS
ESTATE AGENTS

Fine and Country Dorset Sales Poole, Dorset BH14 8UD

www.edwardestates.com 01202 744944

www.fineandcountry.com

FINE & COUNTRY
Homes from Edwards