

Local expertise with powerful national marketing

EDWARDS
ESTATE AGENTS

GROVE ROAD

BOURNEMOUTH, BH1 3DZ

FINE & COUNTRY
Homes from Edwards



GUIDE PRICE £350,000

The main entrance is entry phone protected for the residents privacy and security. The communal entrance hallway, is very spacious and welcoming. There is an onsite concierge who looks after the running of the building and monitors security. A passenger lift or stairs will take you up to the first floor.

Accommodation comprises of large bright lounge with access to sunroom, dining room accessed via either double doors from the lounge or via a door from the kitchen.

Two double bedrooms both with high quality fitted wardrobes and dressing tables, contemporary en suite bathroom to the master bedroom, family bathroom with panelled bath.

Other benefits include secure underground parking space, onsite concierge and beautifully landscaped communal gardens which enjoy far reaching views from the Purbecks to the Isle of Wight.

Location:

The East cliff is perfectly located with the award winning safe sandy beaches directly beneath you which enjoy the warmest sea temperatures in the UK and offer stunning views of the Isle of Wight and the Purbecks.

Just a short walk away are the superb shopping and leisure facilities in Bournemouth Town Centre which offer an excellent range of shops, bars and restaurants.

The Bournemouth Wessex Way is very close and gives direct access to the M27 motorway with London just 2 hours commute. There are also main line train routes from either Poole or Bournemouth railway stations which connect the Weymouth to London Waterloo South West train service.









GROUND FLOOR

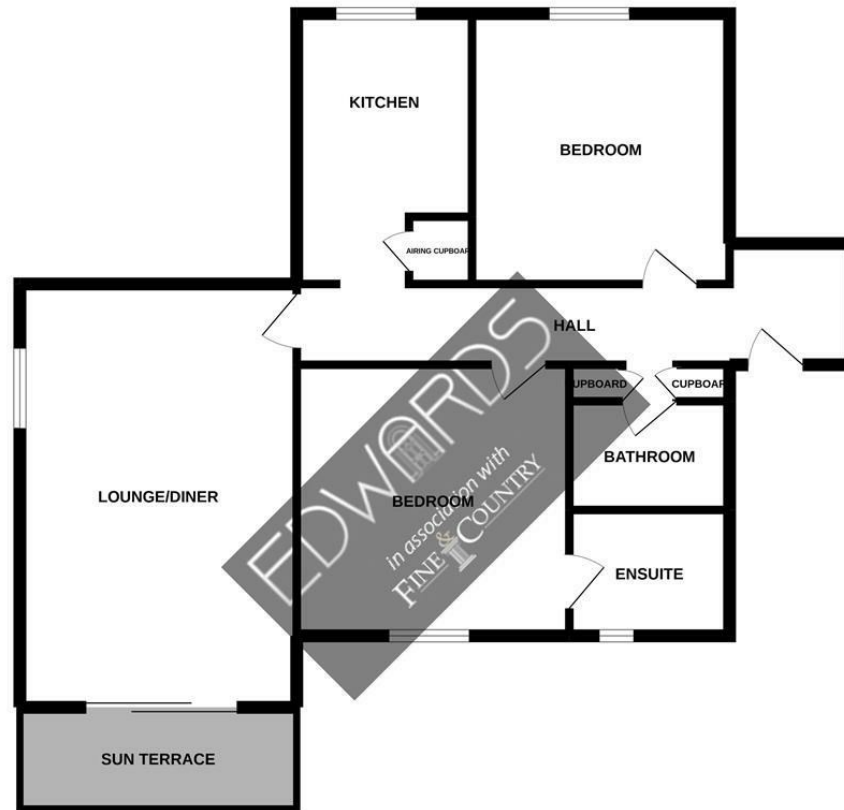

Whilst every attempt has been made to ensure the accuracy of the floorplan contained here, measurements of doors, windows, rooms and any other items are approximate and no responsibility is taken for any error, omission or mis-statement. This plan is for illustrative purposes only and should be used as such by any prospective purchaser. The services, systems and appliances shown have not been tested and no guarantee as to their operability or efficiency can be given.
Made with Metropix ©2022

These particulars are believed to be correct but their accuracy is not guaranteed and they do not form part of any contract. Whilst every effort is made to ensure the accuracy of these details, it should be noted that the above measurements are approximate only. Floorplans are for representation purposes only and prepared according to the RICS Code of Measuring Practice by our floorplan provider. Therefore, the layout of doors, windows and rooms are approximate and should be regarded as such by any prospective purchaser. Any internal photographs are intended as a guide only and it should not be assumed that any of the furniture/ fittings are included in any sale. Where shown, details of lease, ground rent and service charge are provided by the vendor and their accuracy cannot be guaranteed, as the information may not have been verified and further checks should be made either through your solicitor/conveyancer or by referring to the home information pack for this property. Where appliances, including central heating, are mentioned, it cannot be assumed that they are in working order, as they have not been tested. Please also note that wiring, plumbing and drains have not been checked.

Local expertise with powerful national marketing



Fine and Country Dorset Sales Poole, Dorset BH14 8UD

www.edwardestates.com 01202 744944

www.fineandcountry.com

