

*Local expertise with powerful national marketing*

EDWARDS  
ESTATE AGENTS



**FRENCHS FARM ROAD**

POOLE, BH16 5RT







# PRICE GUIDE £485,000

---

A three bedroom bungalow located in the heart of Upton, close to local shops, amenities and Upton Junior School.

When entering this spacious bungalow you are welcomed into a porch area which leads through to the large hallway with all principle doors leading off.

Just off the hall to the right is the kitchen which comprises of: white wall and base units, grey granite effect worktops, free standing range style cooker, extractor fan, tiled splash back, boiler, door opening onto the patio area and window letting in ample light. There is also a glass hatch which opens into the dining room for ease of passing food and drinks through. The dining room has space for an 8 seater table, glass cabinet and large sliding doors opening into the impressive garden room. The Garden room is very spacious and very bright with 3 side having windows all the way down and two sky lights. This room is perfect for entertaining and/or relaxing all year round. Second set of sliding doors in the garden room open into the large lounge with a feature fire place, large window over looking the front aspect.

The accommodation comprise of: Two Large double bedrooms both with ample storage space and an en-suite. The third bedroom is a single room, currently being used as a utility room and a WC opposite.

The front and rear garden are both low maintenance with patio and stoned areas. The garden is an ideal place for catching the sun and perfect for entertaining on the patio area. There is ample parking at the front of the property with a long drive way leading down the the garage.

Situated in the popular Upton area of Poole, within Upton and Lytchett Minster school catchment, close to local amenities, bus routes and walking distance to Upton Nature Reserve.

Energy Performance Rating D  
Council Tax Band E



# Local expertise with powerful national marketing

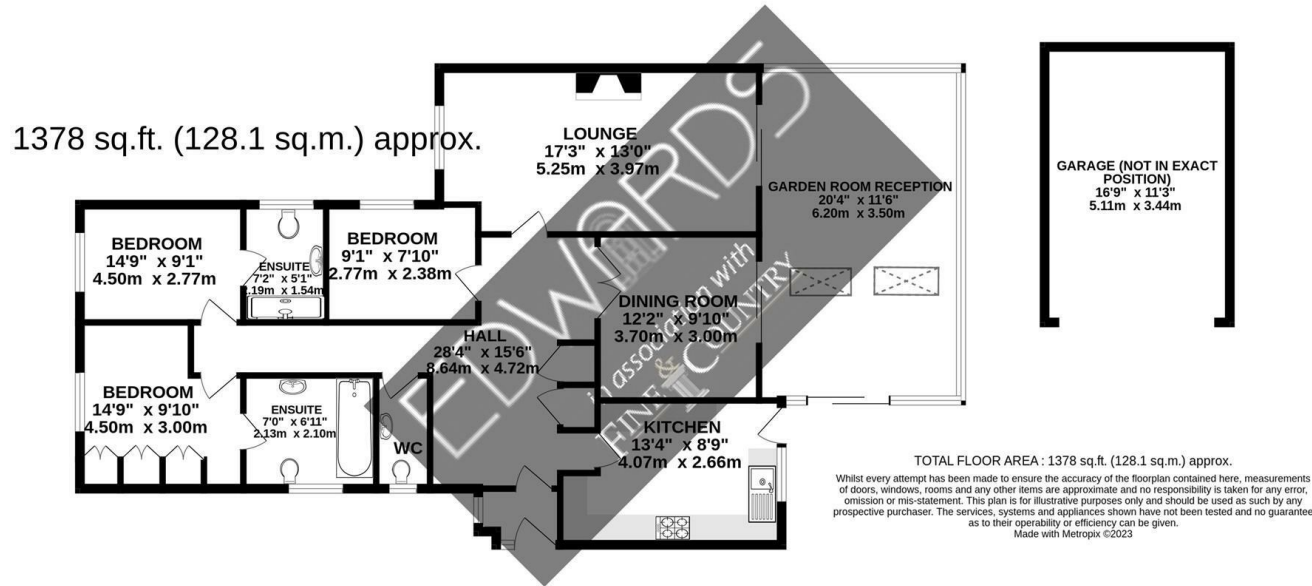

## Ferndown Office

404 Ringwood Road, Ferndown, Dorset, BH22 9AU • [www.edwardstates.com](http://www.edwardstates.com)  
01202 855595

EDWARDS  
ESTATE AGENTS

These particulars are believed to be correct but their accuracy is not guaranteed and they do not form part of any contract. Whilst every effort is made to ensure the accuracy of these details, it should be noted that the above measurements are approximate only. Floorplans are for representation purposes only and prepared according to the RICS Code of Measuring Practice by our floorplan provider. Therefore, the layout of doors, windows and rooms are approximate and should be regarded as such by any prospective purchaser. Any internal photographs are intended as a guide only and it should not be assumed that any of the furniture/ fittings are included in any sale. Where shown, details of lease, ground rent and service charge are provided by the vendor and their accuracy cannot be guaranteed, as the information may not have been verified and further checks should be made either through your solicitor/conveyancer or by referring to the home information pack for this property. Where appliances, including central heating, are mentioned, it cannot be assumed that they are in working order, as they have not been tested. Please also note that wiring, plumbing and drains have not been checked.