

*Local expertise with powerful national marketing*

EDWARDS  
ESTATE AGENTS

HARRIER DRIVE

WIMBORNE, BH21 1XE



# GUIDE PRICE £585,000

---

An attractive and immaculately presented FOUR BEDROOM detached family home with beautiful bathroom and en suite shower room, SUNNY SOUTHERLY FACING REAR GARDEN and DOUBLE GARAGE. Located in a quiet, tucked away position the property is just a short stroll from WIMBORNE TOWN CENTRE, Castleman Trailway, the very popular Merley first school, and backs onto The Willett Arms Pub.

Access is via an entrance porch into the entrance hallway with beautifully laid wood effect flooring and downstairs cloakroom and stairs rising to the first floor.

Generous in size, the living room has features a bow window and fireplace with inset living flame gas fire.

Situated at the rear, the formal dining room leads through to the conservatory which has a beautiful view out over the rear garden.

With plenty of space for a dining table and chairs, the sizeable kitchen/breakfast room is fitted with a comprehensive range of units and integrated appliances to include a double oven, gas hob, dishwasher and fridge/freezer. There is also a separate utility room which has access to the double garage and rear garden.

Bright and spacious, first floor landing gives access to all four bedrooms. Three of the bedrooms have built in wardrobes the master also benefits from a beautifully presented en suite shower room. All other bedrooms are serviced by a beautifully appointed family bathroom.

Externally at the front, there is a beautifully maintained lawn and rockery plus a generous block paved driveway providing parking for several vehicles and leading through to the double garage. Beautifully maintained, the southerly facing rear garden has a patio area, mature shrub and flower borders and greenhouse.

Energy Performance Rating B  
Council Tax Band F



# Local expertise with powerful national marketing

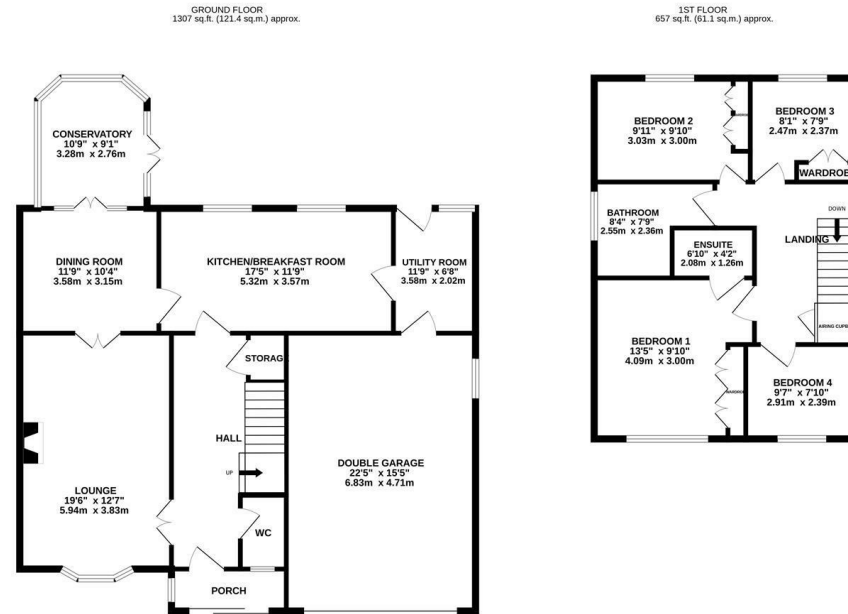

TOTAL FLOOR AREA - 1964 sq. ft. (182.5 sq.m.) approx.  
Whilst every attempt has been made to ensure the accuracy of the floorplan contained here, measurements of doors, windows, rooms and any other items are approximate and no responsibility is taken for any error, omission or mis-statement. This plan is for illustrative purposes only and should be used as such by any prospective purchaser. The services, systems and appliances shown have not been tested and no guarantee as to their operability or efficiency can be given.  
Made with Skettop® R2024

## Ferndown Office

404 Ringwood Road, Ferndown, Dorset, BH22 9AU • [www.edwardstates.com](http://www.edwardstates.com)  
01202 855595

EDWARDS  
ESTATE AGENTS

These particulars are believed to be correct but their accuracy is not guaranteed and they do not form part of any contract. Whilst every effort is made to ensure the accuracy of these details, it should be noted that the above measurements are approximate only. Floorplans are for representation purposes only and prepared according to the RICS Code of Measuring Practice by our floorplan provider. Therefore, the layout of doors, windows and rooms are approximate and should be regarded as such by any prospective purchaser. Any internal photographs are intended as a guide only and it should not be assumed that any of the furniture/ fittings are included in any sale. Where shown, details of lease, ground rent and service charge are provided by the vendor and their accuracy cannot be guaranteed, as the information may not have been verified and further checks should be made either through your solicitor/conveyancer or by referring to the home information pack for this property. Where appliances, including central heating, are mentioned, it cannot be assumed that they are in working order, as they have not been tested. Please also note that wiring, plumbing and drains have not been checked.