

Local expertise with powerful national marketing

EDWARDS
ESTATE AGENTS

GLENFERNESS AVENUE

DORSET, BH3 7EX



£2,900 PER MONTH

- Detached house recently redecorated
- Four double bedrooms
- Three reception rooms
- En suite to the master
- Kitchen breakfast room
- Utility
- Double garage
- Beautifully landscaped gardens
- Gardener including
- Unfurnished

A four bedroom detached house with three reception rooms, en suite to the master bedroom, detached double garage and stunning mature gardens.

Located within enviable Talbot Woods, this spacious property's ground floor accommodation comprises an entrance hall, cloakroom, triple aspect living room with feature fireplace and patio doors to the garden, dining room overlooking the garden, study, utility room and a kitchen breakfast room.

Upstairs the property benefits from a well proportioned dual aspect master bedroom which has been fitted with a comprehensive range of units, in addition to a spacious en suite bathroom with bath, wc, wash hand basin and walk in shower cubicle. There are also three further double bedrooms which benefit from built in wardrobes and which are serviced by the main family bathroom with shower over bath.

Outside the property enjoys a high degree of seclusion with its mature and well stocked



gardens (gardener included) to front and back. Its driveway provides ample parking and leads to the detached double garage. Offered on an unfurnished basis Available Now





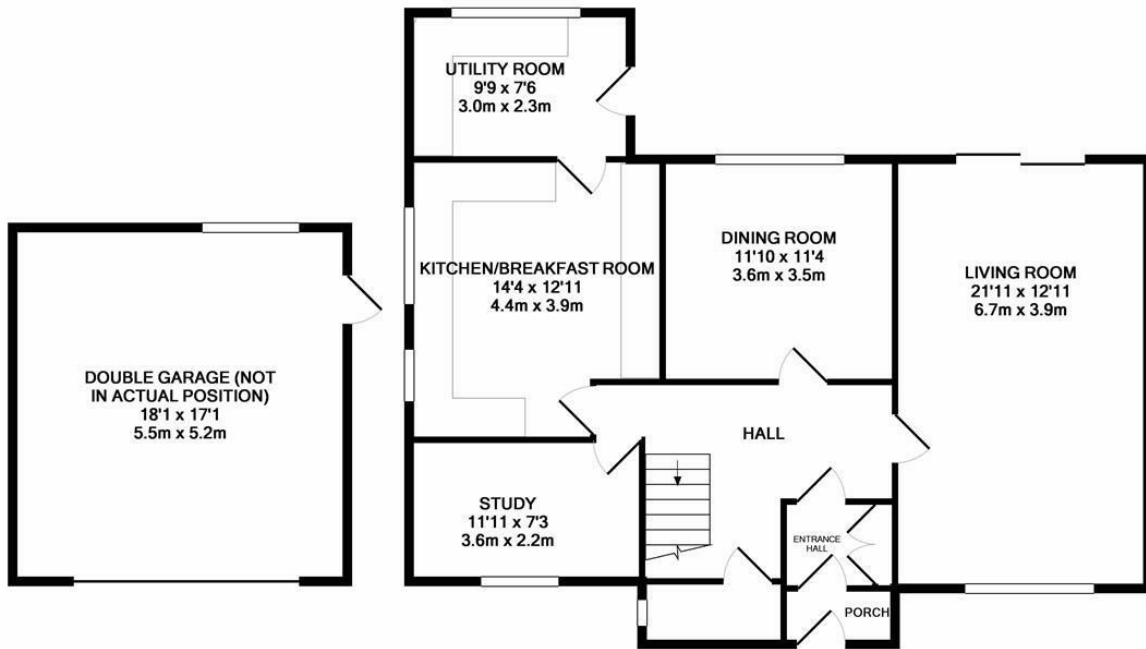

GROUND FLOOR
APPROX. FLOOR
AREA 1249 SQ.FT.
(116.0 SQ.M.)

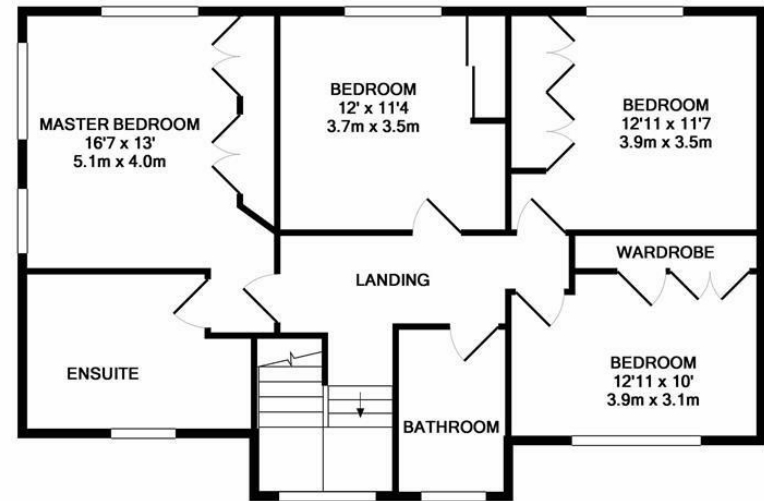

1ST FLOOR
APPROX. FLOOR
AREA 857 SQ.FT.
(79.6 SQ.M.)

GLENFERNESS AVENUE, BOURNEMOUTH, DORSET BH3 7EX
TOTAL APPROX. FLOOR AREA 2106 SQ.FT. (195.6 SQ.M.)

Whilst every attempt has been made to ensure the accuracy of the floor plan contained here, measurements of doors, windows, rooms and any other items are approximate and no responsibility is taken for any error, omission, or mis-statement. This plan is for illustrative purposes only and should be used as such by any prospective purchaser. The services, systems and appliances shown have not been tested and no guarantee as to their operability or efficiency can be given.
Made with Metropix ©2017

These particulars are believed to be correct but their accuracy is not guaranteed and they do not form part of any contract. Whilst every effort is made to ensure the accuracy of these details, it should be noted that the above measurements are approximate only. Floorplans are for representation purposes only and prepared according to the RICS Code of Measuring Practice by our floorplan provider. Therefore, the layout of doors, windows and rooms are approximate and should be regarded as such by any prospective purchaser. Any internal photographs are intended as a guide only and it should not be assumed that any of the furniture/ fittings are included in any sale. Where shown, details of lease, ground rent and service charge are provided by the vendor and their accuracy cannot be guaranteed, as the information may not have been verified and further checks should be made either through your solicitor/conveyancer or by referring to the home information pack for this property. Where appliances, including central heating, are mentioned, it cannot be assumed that they are in working order, as they have not been tested. Please also note that wiring, plumbing and drains have not been checked.

Local expertise with powerful national marketing



Ferndown, Dorset BH22 9AU

01202 039918

www.edwardstates.co.uk