

*Local expertise with powerful national marketing*

EDWARDS  
ESTATE AGENTS

**WOODLINKEN DRIVE**  
VERWOOD, BH31 6BN







# GUIDE PRICE £565,000

This EXECUTIVE STYLE BUNGALOW is immaculately presented offering QUALITY fixtures and fittings throughout. The property comprises three double bedrooms, en-suite, sizeable living room, a generous kitchen/diner, underfloor heating throughout and a low maintenance landscaped rear garden.

Energy Performance Rating B  
Council Tax Band E





A beautifully tiled floor in the entrance hallway continues through to the kitchen/diner and utility. There is access to loft hatch and large cupboard with slatted shelving for linen storage.

All three bedrooms are generous doubles. The master is the largest at the front and further benefits from an en-suite shower room and fitted wardrobes. Bedrooms two, three and guests are serviced by a four-piece family bathroom.

There is a spacious living room at the rear of the property, with windows and French doors having a view and leading out to the rear patio and garden.

The sizeable dual aspect kitchen/diner has been fitted with a range of matching eye and base level units, granite work tops and splashback, integrated sink unit with mixer tap and built-in granite drainer, dishwasher, fridge and freezer, four gas hob with extractor fan over, waist high double oven and grill, and there is ample space for a dining table and chairs plus a sofa if required. French doors lead out to the rear patio and garden. Complimenting the kitchen is the separate utility room.

Outside there is tarmac driveway and integral garage providing parking for several vehicles; surrounded by block paviour. The rear garden has an expanse of patio immediately abutting the living room, the rest is mainly laid to astro turf with well stocked flower and shrub borders.



**GROUND FLOOR**  
1452 sq.ft. (134.9 sq.m.) approx.

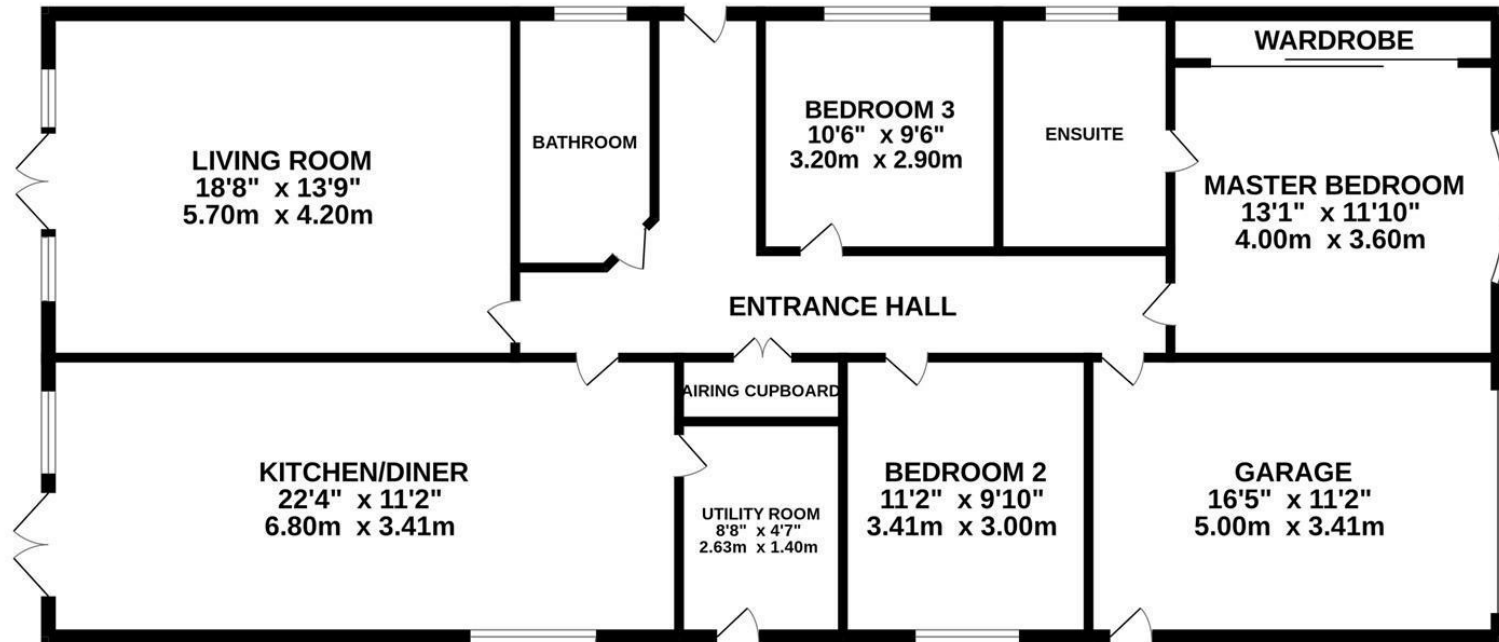

TOTAL FLOOR AREA : 1452 sq.ft. (134.9 sq.m.) approx.

Whilst every attempt has been made to ensure the accuracy of the floorplan contained here, measurements of doors, windows, rooms and any other items are approximate and no responsibility is taken for any error, omission or mis-statement. This plan is for illustrative purposes only and should be used as such by any prospective purchaser. The services, systems and appliances shown have not been tested and no guarantee as to their operability or efficiency can be given.  
Made with Metropix ©2024

These particulars are believed to be correct but their accuracy is not guaranteed and they do not form part of any contract. Whilst every effort is made to ensure the accuracy of these details, it should be noted that the above measurements are approximate only. Floorplans are for representation purposes only and prepared according to the RICS Code of Measuring Practice by our floorplan provider. Therefore, the layout of doors, windows and rooms are approximate and should be regarded as such by any prospective purchaser. Any internal photographs are intended as a guide only and it should not be assumed that any of the furniture/ fittings are included in any sale. Where shown, details of lease, ground rent and service charge are provided by the vendor and their accuracy cannot be guaranteed, as the information may not have been verified and further checks should be made either through your solicitor/conveyancer or by referring to the home information pack for this property. Where appliances, including central heating, are mentioned, it cannot be assumed that they are in working order, as they have not been tested. Please also note that wiring, plumbing and drains have not been checked.



*Local expertise with powerful national marketing*

EDWARDS  
ESTATE AGENTS

**Ferndown Office**

404 Ringwood Road, Ferndown, Dorset, BH22 9AU • [www.edwardstates.com](http://www.edwardstates.com)  
01202 855595