

*Local expertise with powerful national marketing*

EDWARDS  
ESTATE AGENTS

RAYMOND CLOSE

VERWOOD BH31 6DL





SINCE  
NAME  
ONE GIVES  
MISTAKES



HOME

A LOVELY LADY  
AND A GRUMPY  
OLD MAN  
LIVE HERE



# £1,350 PER MONTH

- Detached Bungalow
- Two double bedrooms
- Two receptions
- Modern fitted kitchen
- Modern bathroom
- Garage
- Mature gardens
- Unfurnished

A beautiful detached two bedroom, two reception room bungalow in a quiet cul de sac position just off Lake Road in Verwood.

The property comprises an entrance porch, entrance hall with storage cupboards, a modern fitted kitchen with oven, hob, fridge freezer and dishwasher, a large living room with gas fire and sliding patio doors to the garden, steps down to the dining room with sliding doors to a conservatory overlooking the gardens. There are two double bedrooms, one with built in wardrobes, which are serviced by a modern bathroom with shower over bath.

The property is located in a quiet cul de sac position, its driveway provides parking for two cars and leads to the attached garage with workshop/utility room to the rear. A side gate leads onto a private patio area with raised flower bed. The pathway leads around the conservatory to the area of lawn at the rear of the property.



Agents note, the landlord will maintain the flower beds and shrubs on a bi annual basis, however the tenants are liable to cut the lawn.













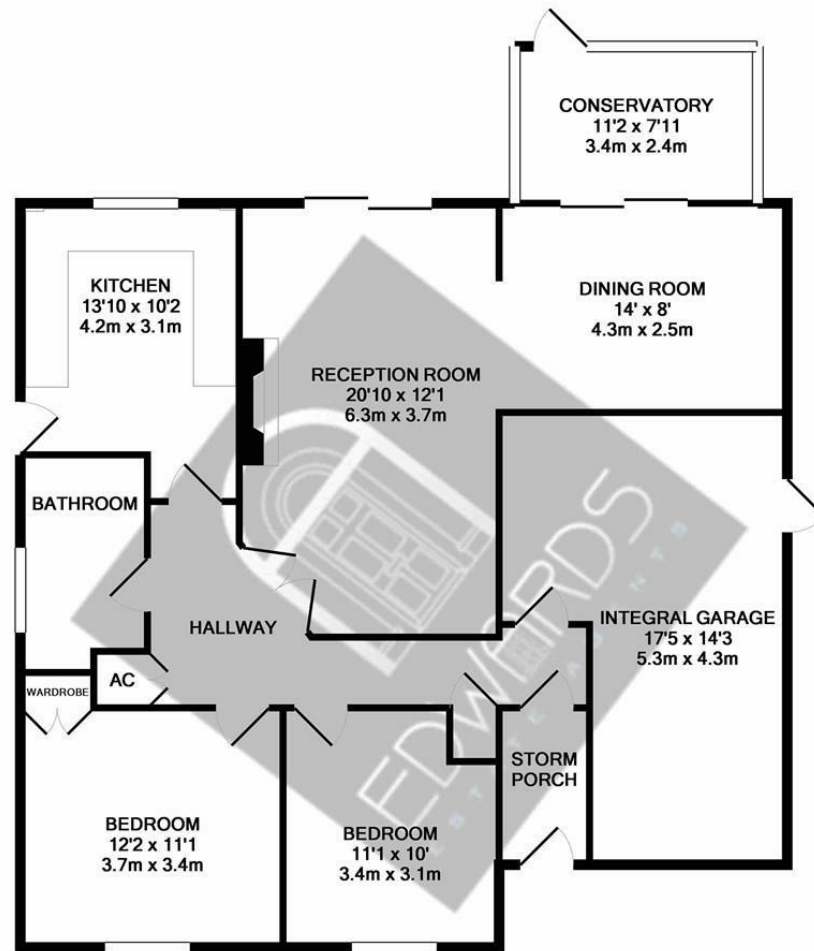

RAYMOND CLOSE, VERWOOD, DORSET BH31 6DL  
TOTAL APPROX. FLOOR AREA 1262 SQ.FT. (117.2 SQ.M.)

Whilst every attempt has been made to ensure the accuracy of the floor plan contained here, measurements of doors, windows, rooms and any other items are approximate and no responsibility is taken for any error, omission, or mis-statement. This plan is for illustrative purposes only and should be used as such by any prospective purchaser. The services, systems and appliances shown have not been tested and no guarantee as to their operability or efficiency can be given.  
Made with Metropix ©2018

These particulars are believed to be correct but their accuracy is not guaranteed and they do not form part of any contract. Whilst every effort is made to ensure the accuracy of these details, it should be noted that the above measurements are approximate only. Floorplans are for representation purposes only and prepared according to the RICS Code of Measuring Practice by our floorplan provider. Therefore, the layout of doors, windows and rooms are approximate and should be regarded as such by any prospective purchaser. Any internal photographs are intended as a guide only and it should not be assumed that any of the furniture/ fittings are included in any sale. Where shown, details of lease, ground rent and service charge are provided by the vendor and their accuracy cannot be guaranteed, as the information may not have been verified and further checks should be made either through your solicitor/conveyancer or by referring to the home information pack for this property. Where appliances, including central heating, are mentioned, it cannot be assumed that they are in working order, as they have not been tested. Please also note that wiring, plumbing and drains have not been checked.



*Local expertise with powerful national marketing*

EDWARDS  
ESTATE AGENTS

Ferndown, Dorset BH22 9AU

01202 039918

[www.edwardstates.co.uk](http://www.edwardstates.co.uk)