

LAKE ROAD
VERWOOD, BH31 6BX



GUIDE PRICE £625,000

- NO FORWARD CHAIN
- DETACHED FAMILY HOME
- LARGE PLOT
- FIVE DOUBLE BEDROOMS
- STYLISH KITCHEN
- DINING FAMILY ROOM & SEPARATE LOUNGE
- TWO BATHROOMS AND GROUND FLOOR CLOAKROOM
- ATTACHED GARAGE
- AMPLE OFF ROAD PARKING
- GENEROUS REAR GARDEN

This FIVE DOUBLE BEDROOM DETACHED FAMILY HOME comes to the market for the first time in some 40 years! Set within a LARGE PLOT offering PARKING FOR NUMEROUS VEHICLES and a GENEROUS REAR GARDEN. Accommodation also includes a LOUNGE/DINING ROOM and KITCHEN/FAMILY ROOM providing versatile family living.



The welcoming entrance hall has stairs rising to the first floor and access to a downstairs WC. Further ground floor accommodation includes a well proportioned living room overlooking the front of the property with connecting French doors to a dining/family room plus further French doors opening out to the rear garden and extensive patio. There is also access to a useful understairs cupboard. Further double doors from this room lead to a stylishly fitted kitchen which also has a door leading to outside.

On the first floor, the five double bedrooms are served by two fully tiled bathrooms fitted with classic white suites.

The attached garage has a fitted sink and pedestrian door to the rear garden. There is ample off road parking to the front of the property and the rear garden is a generous size, laid to patio areas, lawn and raised beds and a garden shed towards the rear of the plot.

Additional Information

Energy Performance Rating: D

Council Tax Band: E

Tenure: Freehold

Agents Note: The extensions were done in the 1980's and there is no completion paperwork available

Flood Risk: but refer to gov.uk, check long term flood risk

Flooded in the last 5 years: No

Conservation area: No

Listed building: No

Tree Preservation Order: No

Restricted Covenants: Yes

Parking: Private driveway & garage

Utilities: Mains electricity, mains gas, mains water

Drainage: Mains sewerage

Broadband: Refer to Ofcom website

Mobile Signal: Refer to Ofcom website



GROUND FLOOR
926 sq.ft. (86.0 sq.m.) approx.

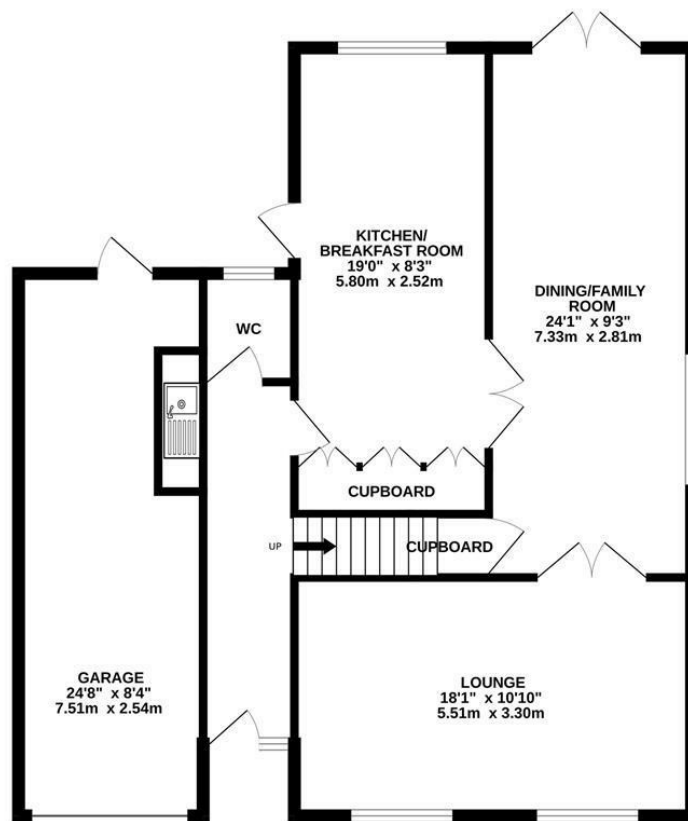

1ST FLOOR
630 sq.ft. (58.6 sq.m.) approx.



TOTAL FLOOR AREA: 1557 sq.ft. (144.6 sq.m.) approx.

Whilst every attempt has been made to ensure the accuracy of the floorplan contained here, measurements of doors, windows, rooms and any other items are approximate and no responsibility is taken for any error, omission or mis-statement. This plan is for illustrative purposes only and should be used as such by any prospective purchaser. The services, systems and appliances shown have not been tested and no guarantee as to their operability or efficiency can be given.
Made with Metropix ©2025

These particulars are believed to be correct but their accuracy is not guaranteed and they do not form part of any contract. Whilst every effort is made to ensure the accuracy of these details, it should be noted that the above measurements are approximate only. Floorplans are for representation purposes only and prepared according to the RICS Code of Measuring Practice by our floorplan provider. Therefore, the layout of doors, windows and rooms are approximate and should be regarded as such by any prospective purchaser. Any internal photographs are intended as a guide only and it should not be assumed that any of the furniture/ fittings are included in any sale. Where shown, details of lease, ground rent and service charge are provided by the vendor and their accuracy cannot be guaranteed, as the information may not have been verified and further checks should be made either through your solicitor/conveyancer or by referring to the home information pack for this property. Where appliances, including central heating, are mentioned, it cannot be assumed that they are in working order, as they have not been tested. Please also note that wiring, plumbing and drains have not been checked.

Ferndown Office

404 Ringwood Road, Ferndown, Dorset, BH22 9AU • www.edwardstates.com
01202 855595